





LAY-OUT PLAN SHOWING FOR PROPOSED PLOTS IN  
 SHARMA COLONY OF SHRI MADAN MOHAN SHARMA % SHRI NAND  
 RAM SHARMA ON R.H.M.T. PURA ROAD NEAR JALAL MUNSHI JI RA BAGH

SCALE = 1 INCH = 16 FT

J.P.P.R.

EXISTING PLOTS OF SATYA COLONY

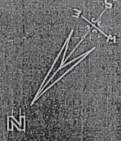

- REFERENCE IN
- Plot no. 1 = 51.07 S.A. YDS.
  - Plot no. 2 = 22.17 S.A. YDS.
  - Plot no. 3 = 27.67 S.A. YDS.
  - Plot no. 4 = 24.67 S.A. YDS.
  - Plot no. 5 = 24.40 S.A. YDS.
  - Plot no. 6 = 177.67 S.A. YDS.
  - Plot no. 7 = 189.33 S.A. YDS.
  - Plot no. 8 = 132.80 S.A. YDS.
  - Plot no. 9 = 227.39 S.A. YDS.
  - Plot no. 10 = 248.33 S.A. YDS.
  - TOTAL PLOTS AREA = 2608.60 S.A. YDS.
  - ROAD AREA = 51.19 S.A. YDS.
  - TOTAL LAND AREA = 3157.79 S.A. YDS.

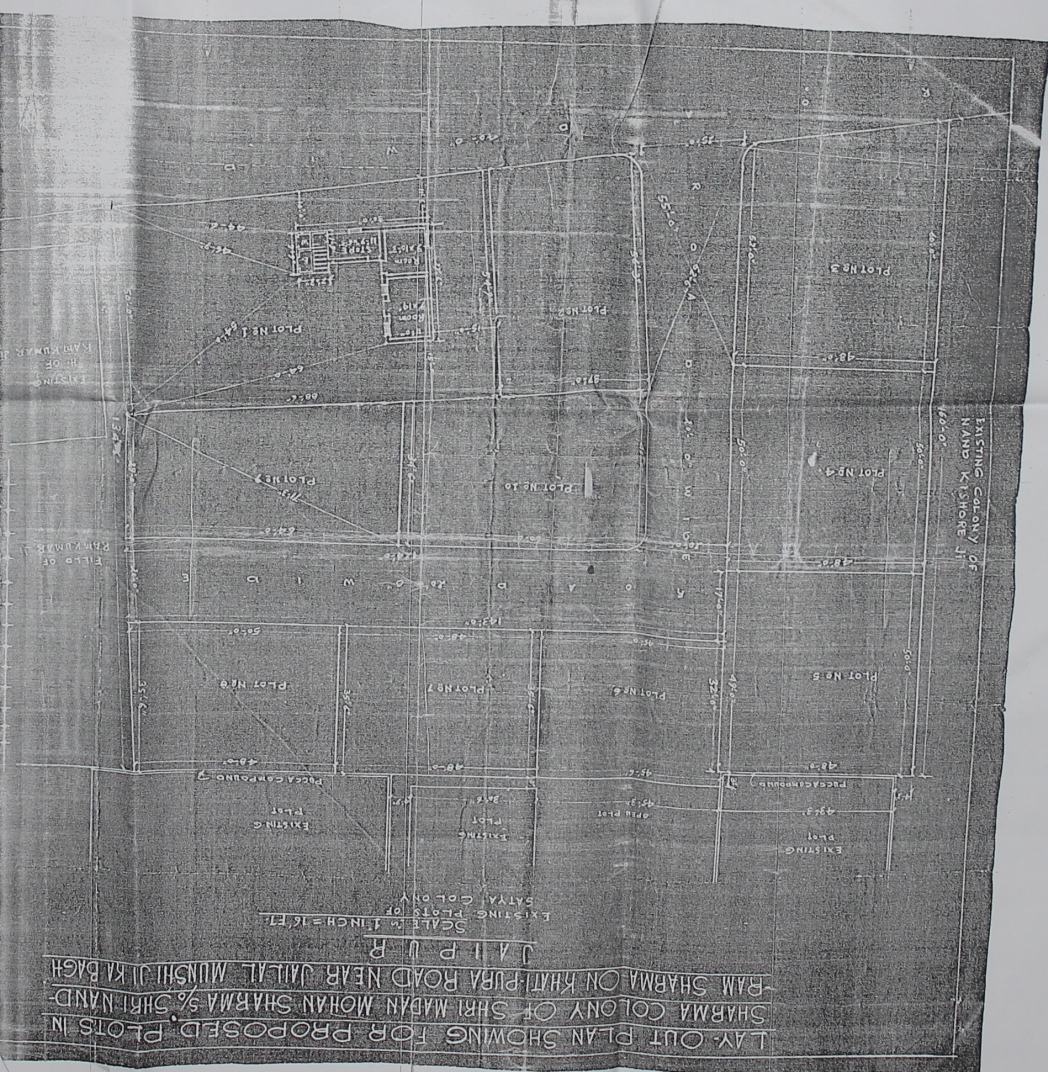



33-A

LAY OUT PLAN SHOWING FOR PROPOSED PLOTS IN  
SHARMA COLONY OF SHRI MADAN MOHAN SHARMA & SHRI NAND-  
RAM SHARMA ON RYMT PURA ROAD NEAR JALAL MUNSHI JI RA BAGH  
JALPURA

EXISTING PLOT OF  
SATYA COLONY  
SCALE 1" INCH = 16 FT.



- BEERANCE IN
- Plot No. 1 = 51.07 50. Yds.
- Plot No. 2 = 22.01 50. Yds.
- Plot No. 3 = 238.47 50. Yds.
- Plot No. 4 = 266.67 50. Yds.
- Plot No. 5 = 264.00 50. Yds.
- Plot No. 6 = 177.49 50. Yds.
- Plot No. 7 = 189.33 50. Yds.
- Plot No. 8 = 193.88 50. Yds.
- Plot No. 9 = 227.99 50. Yds.
- Plot No. 10 = 248.83 50. Yds.
- Plot No. 11 = 260.60 50. Yds.
- Plot No. 12 = 319.79 50. Yds.
- ROAD AREA = 511.9 50. Yds.
- TOTAL LAND AREA = 3197.79 50. Yds.



EXISTING COLONY OF  
NAND K SHORE JI  
100.00

PLOT NO. 12

PLOT NO. 11

PLOT NO. 10

PLOT NO. 9

PLOT NO. 8

PLOT NO. 7

PLOT NO. 6

PLOT NO. 5

PLOT NO. 4

PLOT NO. 3

PLOT NO. 2

PLOT NO. 1

PLOT NO. 12

PLOT NO. 11

PLOT NO. 10

PLOT NO. 9

PLOT NO. 8

PLOT NO. 7

PLOT NO. 6

PLOT NO. 5

PLOT NO. 4

PLOT NO. 3

PLOT NO. 2

PLOT NO. 1

PLOT NO. 12

PLOT NO. 11

PLOT NO. 10

PLOT NO. 9

PLOT NO. 8

PLOT NO. 7

PLOT NO. 6

PLOT NO. 5

PLOT NO. 4

PLOT NO. 3

PLOT NO. 2

PLOT NO. 1

PLOT NO. 12

PLOT NO. 11

PLOT NO. 10

PLOT NO. 9

PLOT NO. 8

PLOT NO. 7

PLOT NO. 6

PLOT NO. 5

PLOT NO. 4

PLOT NO. 3

PLOT NO. 2

PLOT NO. 1

PLOT NO. 12

PLOT NO. 11

PLOT NO. 10

PLOT NO. 9

PLOT NO. 8

PLOT NO. 7

PLOT NO. 6

PLOT NO. 5

PLOT NO. 4

PLOT NO. 3

PLOT NO. 2

PLOT NO. 1

PLOT NO. 12

PLOT NO. 11

PLOT NO. 10

PLOT NO. 9

PLOT NO. 8

PLOT NO. 7

PLOT NO. 6

PLOT NO. 5

PLOT NO. 4

PLOT NO. 3

PLOT NO. 2

PLOT NO. 1

PLOT NO. 12

PLOT NO. 11



LAY OUT PLAN SHOWING FOR PROPOSED PLOTS IN  
 SHARMA COLONY OF SHRI MADAN MOHAN SHARMA & SHRI NAND-  
 RAM SHARMA ON KHATI-PURA ROAD NEAR JAIL AT MUNSHIJI KABAUGH  
 JAIPUR

SCALE 1" = 16 FT.  
 EXISTING PLOTS OF  
 BAYAL COLONY

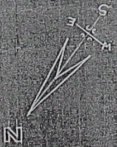

REFERENCE LN

Plot No. 1 = 515.07 50. YDS.

Plot No. 2 = 220.17 50. YDS.

Plot No. 3 = 230.67 50. YDS.

Plot No. 4 = 266.67 50. YDS.

Plot No. 5 = 264.00 50. YDS.

Plot No. 6 = 177.69 50. YDS.

Plot No. 7 = 187.33 50. YDS.

Plot No. 8 = 192.28 50. YDS.

Plot No. 9 = 227.37 50. YDS.

Plot No. 10 = 248.33 50. YDS.

TOTAL PLOTS AREA = 2600.6050 YDS.

TOTAL ROAD AREA = 551.19 50. YDS.

TOTAL LANE AREA = 5157.79 50. YDS.

