

PLOTS OF MUECHUL SOCIETY

PLOTS OF MUECHUL SOCIETY

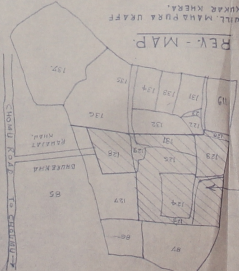
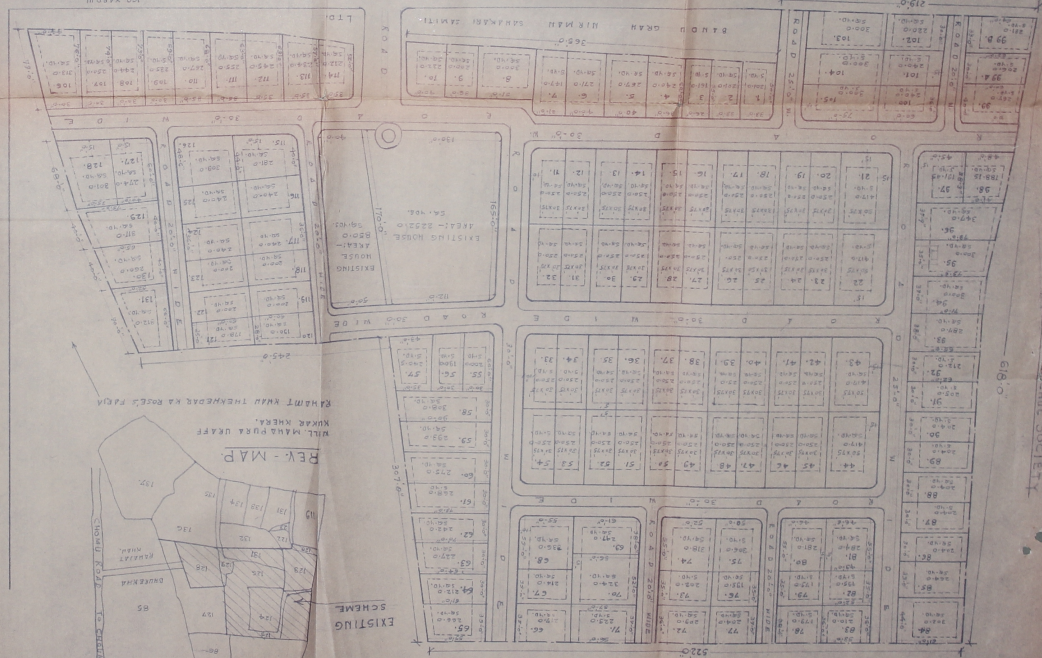

AREA ANALYSIS

- 1. RES. AREA- 3308.0 SA. 105. 70%
- 2. EXISTING AREA- 312.0 SA. 105. 7%
- 3. ROAD AREA- 10832.0 SA. 105. 23%
- 4. TOTAL AREA- 46962.0 SA. 105. 100%

NO. OF PLOTS = 193.

- FULLY BUILT UP
- PARTIALLY BUILT UP
- BOUNDARY WALL
- WATER LINE
- ELECTRIC LINE
- W. M. ROAD
- SCHEME BOUNDARY

SCALE: 1"=50 FT.

A. S. Kulkarni
 SECRETARY
 THE "JAI CHAMUNDA" GRAN NIRMAL
 SAHAKARI SAMITI L T D JAIPUR
 REG. NO. 2489/L

PRESIDENT

15-52 Bigha
A. M. K. K. K.

50 ANINCH

Scale
1" = 50' (1:600)
1" = 100' (1:1200)

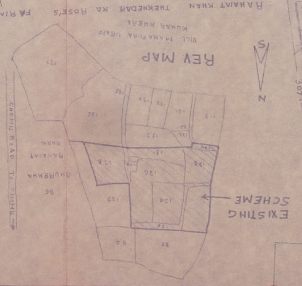
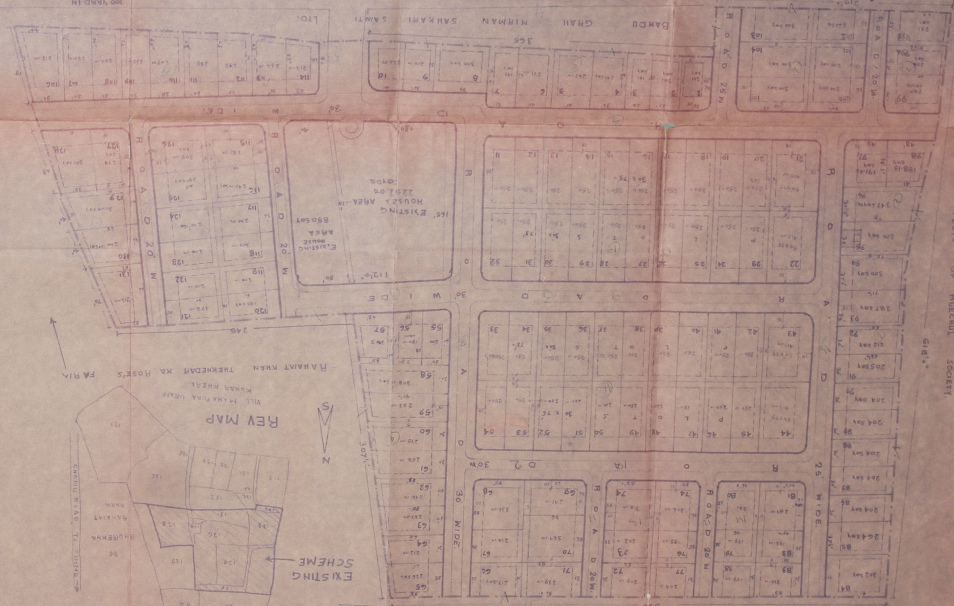

- Purely Aesthetic
- Property Bound in
- Boundary Wall
- WATER LINE
- Electric Line
- W. OR ROAD
- SCHEME BOUNDARY

AREA ANALYSIS

1 RES. AREA
2 EXISTING " (3102) sayds
3 ROADS " 10832 "

TOTAL AREA: 46962 (1+3)
15-52 Bigha

PLOTS OF MUECHUL SOCIETY

PLOTS OF MUECHUL SOCIETY

Area no 2466

9
10

SCALE 50 ANCHING

EXISTING LAY OUT PLAN OF THE "JAI CHAUND" GRAH NIRMAN (RAJ)
 BAHKARI SAMITI LTD SCHEME NO 3 ON CHOUVI ROAD

1:5000
 1" = 100' 0"

J.K. SINGH



PLOTS OF MUECHUL SOCIETY

1:5000

PLOTS OF MUECHUL SOCIETY

Scale no 14485

- FULLY BUILT UP
- PAVING ROAD UP
- COURTYARD WALL
- WATER LINE
- ELECTRIC LINE
- MAIN ROAD
- SCHEME BOUNDARY

AREA ANALYSIS:
 1 RES. AREA 3610 sqyds.
 2 EXISTING " (3102) sqyds
 3 ROADS " 10832 "
 TOTAL AREA 49662 (1+3)
 15.52 Bigha.



REV MAP

EXISTING SCHEME

CHOUVI ROAD

PLANNED NEAR TEKKEDAR KA ROSE'S PARIKH

THE PLANNING OFFICE

RAJASTHAN

JAIPUR

SCHEMATIC

PLAN

NO. 100

1958

1:5000

1" = 100' 0"

50 ANCHING

J.K. SINGH

SCALE 50 METERS
 EXISTING LAY OUT PLAN OF THE JAI CHAMUNDA GRAH NIRMAN
 DHAKARI SAVITI LTD SCHEME NO 3 ON CHOIV ROAD JAI PUR (RAJ)



- SCHEME BOUNDARY
- WATER MAIN
- ELECTRICAL LINE
- M.P. MAIN
- PORTY BUILT UP
- PORTY BOUNDARY

AREA ANALYSIS
 1 RES AREA
 2 EXISTING " 3 ROADS " (3102) sayds
 3030 sayds
 10832
 46962
 TOTAL AREA (1+3)
 15.52 Bigha.

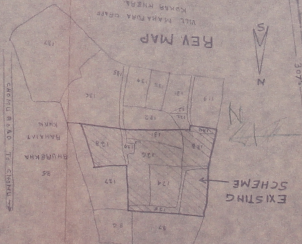

PLOTS OF MUECHL SOCIETY

PLOTS OF MUECHL SOCIETY

सविता-सविति

(1) (2)