

PROPOSED PLOTS IN SCHEME ANAND VIHAR-C
 BELONGS OF SHANKER BHAWAN NIRMAN SAHAKARI SAMITID
 ON KHORA BENAD ROAD JHOTWARA JAIPUR SCALE 1:500

ANAND-VIHAR-C

- REFERENCES
- 1 PLOTS AREA -
 - 2 ROADS AREA -
 - 3 TOTAL LAND AREA -

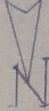

K No
 TEH/DIST - JAIPUR

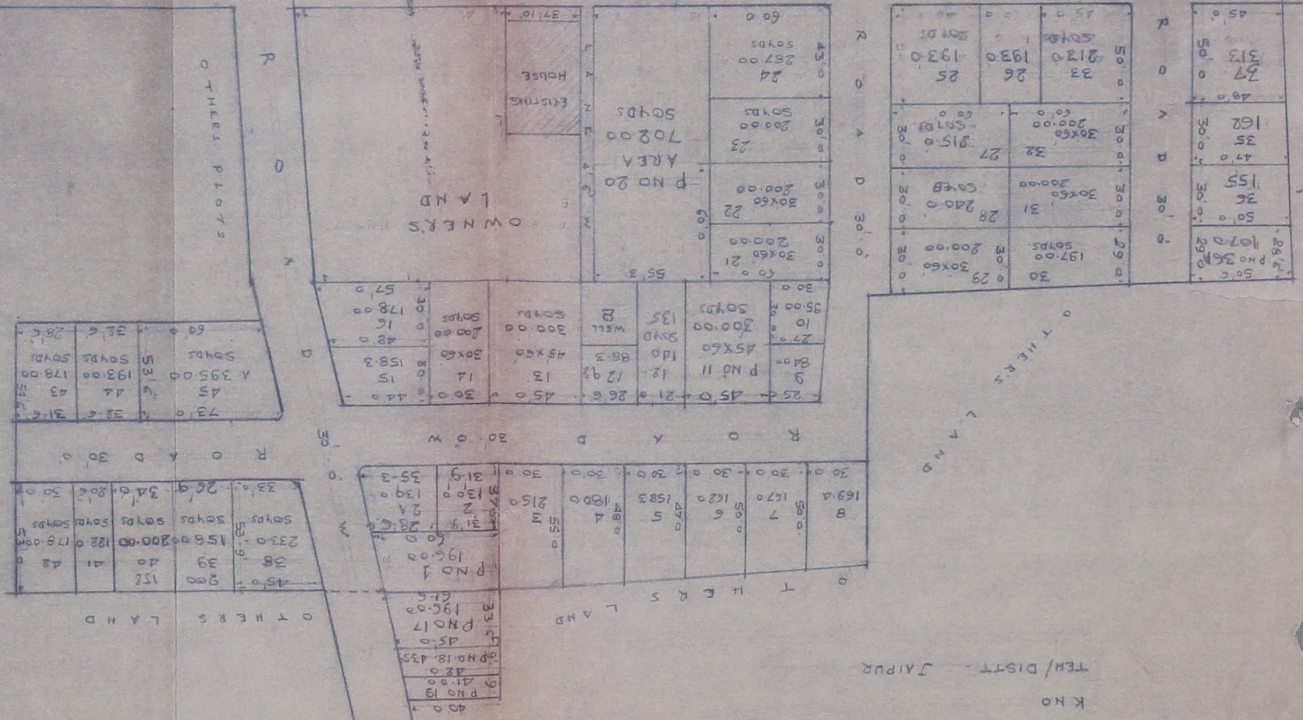

22

98