

# LAY-OUT PLAN OF SCHEME RASTRA PITA MAHATMA GANDHI NAGAR UNDER ANAND BHAWAN NIRMAN SAHAKARI SAMITI LTD.

ON XIMER ROAD, JAIPUR RAJ.

SCALE: 1" = 100' INCH  
REGISTRATION NO. 1294/L



← TO JAIPUR NATIONAL HIGHWAY No. 6 C → TO JAIPUR

# LAY-OUT PLAN OF SCHEME RASTRA PITA MAHATMA GANDHI NAGAR UNDER ANAND BHAWAN NIRMAN SAHAKARI SAMITI LTD.

ON AJMER ROAD, JAIPUR RAJ.

SCALE - 50 FT = 1 INCH.

REGISTRATION No. 1884/1

KHASRA No. 182/3, 183, 185 to 190

VILL - SUSHILPURA



**REF:-**

1. PLOT AREA ..... 60260.0 SQ. YDS.
2. SHOPS AREA ..... 1919.0 SQ. YDS.
3. OPEN ..... 10801.0 SQ. YDS.
4. ROAD ..... 27601.0 SQ. YDS.

**TOTAL :- 100581.0 SQ. YDS.**

33.25 BEEGHAS ONLY.

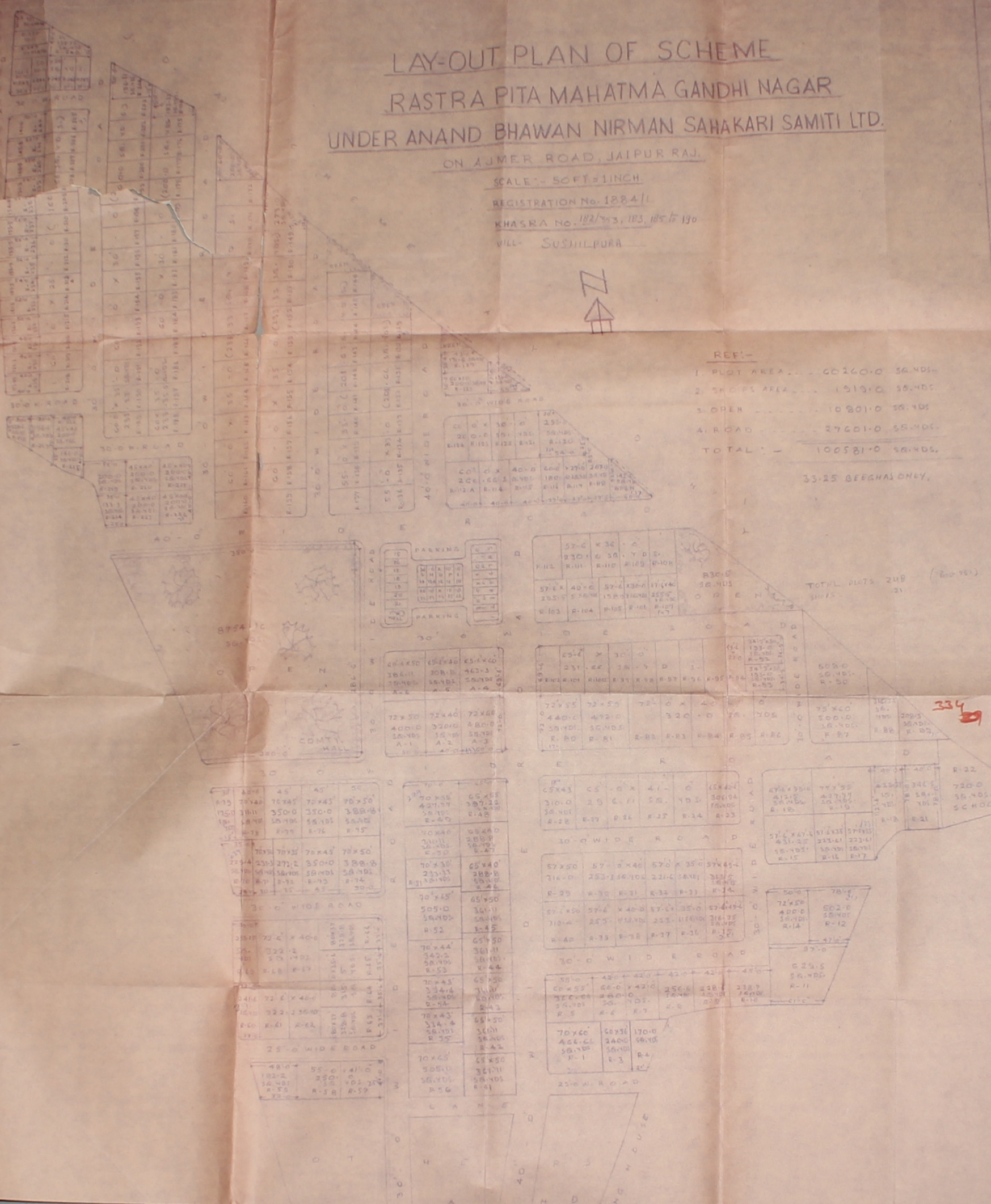

TOTAL PLOTS 248 (800 YDS)  
31

334

SCHOOL

70x45	70x45	70x45	70x50
3111	3500	3500	3888
58.78	58.78	58.78	58.78
R-75	R-75	R-75	R-75

70x55	65x55
427.77	357.22
58.78	58.78
R-75	R-75

65x43	65x43	41x40	65x40
310.0	250.0	50.0	300.0
58.78	58.78	58.78	58.78
R-28	R-27	R-24	R-23

70x50	57x40	57x35	57x45
310.0	250.0	220.0	310.0
58.78	58.78	58.78	58.78
R-25	R-30	R-31	R-32

57x45	57x35	43x35	720.0
431.25	220.0	150.0	58.78
58.78	58.78	58.78	58.78
R-15	R-16	R-17	R-22

70x45	65x40
310.0	280.0
58.78	58.78
R-52	R-47

70x45	65x40
310.0	280.0
58.78	58.78
R-52	R-47

70x45	65x40
310.0	280.0
58.78	58.78
R-52	R-47

70x45	65x40
310.0	280.0
58.78	58.78
R-52	R-47

70x45	65x40
310.0	280.0
58.78	58.78
R-52	R-47

70x45	65x40
310.0	280.0
58.78	58.78
R-52	R-47

70x45	65x40
310.0	280.0
58.78	58.78
R-52	R-47

70x45	65x40
310.0	280.0
58.78	58.78
R-52	R-47

70x45	65x40
310.0	280.0
58.78	58.78
R-52	R-47

70x45	65x40
310.0	280.0
58.78	58.78
R-52	R-47

LAY-OUT PLAN OF SCHEME  
 RASTRA-PITA MAHATMA GANDHI NAGAR  
 UNDER ANAND BHAWAN NIRMAN SAHAKARI SAMITI LTD.  
 ON AJMER ROAD, JAIPUR RAJ.

SCALE - 50 FT. = 1 INCH  
 REGISTRATION No. 1884/L



Plan No 182/553, 183 & 190  
 VILL SUSHILPURA

TO AJMER ← NATIONAL HIGHWAY NO. 6 (AJMER ROAD) → TO JAIPUR

LAY-OUT PLAN OF SCHEME  
 RASTRA PITA MAHATMA GANDHI NAGAR  
 UNDER ANAND BHAWAN NIRMAN SHAKARI SAMITI LTD.

ON 2 MILE ROAD, JAIPUR RAJ.

SCALE: 1" = 50 FT. (1:1524)

REGISTRATION No. 1024/L



S



KM. No. 102/103, 101 & 102  
 Vill. - SUSHILPOORA  
 Tal. - JAIPUR  
 8 Plot Constructed  
 50% Paid  
 50% G. Will

TO JAIPUR →

NATIONAL HIGHWAY No. 6

LAY-OUT PLAN OF SCHEME  
 RASTRA BITA MAHATMA GANDHI NAGAR  
 UNDER ANAND BHAWAN NIRMAN SAHAKARI SAMITI LTD  
 ON AMER ROAD, JAIPUR RAJ.

SCALE - 1:1000 INCH  
 REGISTRATION NO. 1584/L



*Original Plan Received  
 The date of plan and  
 the requirement as per  
 Section 22 clearly show the cooperation  
 from the society, only those  
 things done, which there are  
 better level / ground level are  
 indicated to be in the facility  
 Areas not approved are clearly  
 indicated in the map*

Area	4
Residential	1710
Roads	5.67
Facility	310
<b>TOTAL</b>	<b>21.85</b>
	<b>100.00%</b>

Sub-Committee Formally Approved by the  
 Building Committee on 21.05.1970  
 S.P.C. MEETING DATED 21.05.1970  
 RESOLUTION NO. 1 (FOR P.U.D. OF CONSTRUCTION)  
 s/d/ (S.S.A. RIZVI)  
 DEPUTY TOWN PLANNER  
 JAIPOUR DEVELOPMENT  
 JAIPOUR, RAJASTHAN



K.M. No. 102/103, 107, 105 to 190  
 VILL SUSHIL PURA

*True Copy Attached*  
  
 Sushil Puria  
 15.11.1970