

REVISED LAY OUT PLAN OF PLOTS IN
 SHAKTI NAGAR OF SHANKAR BHAWAN
 NIRMAN SAHAKARI SAMITI LTD, AT
 GOPALPURA BYE PASSES ROAD, JAIPUR-12
 SCALE 1" = 50 FT



AREA	ACRES
PLOTS	4.51
ROAD	2.86
RAM	0.15
CHOPS	
LAND	7.52

REF. KHASRA NO. 216, 207
 GRAM GOPALPURA
 DIST. JAIPUR



29
 120

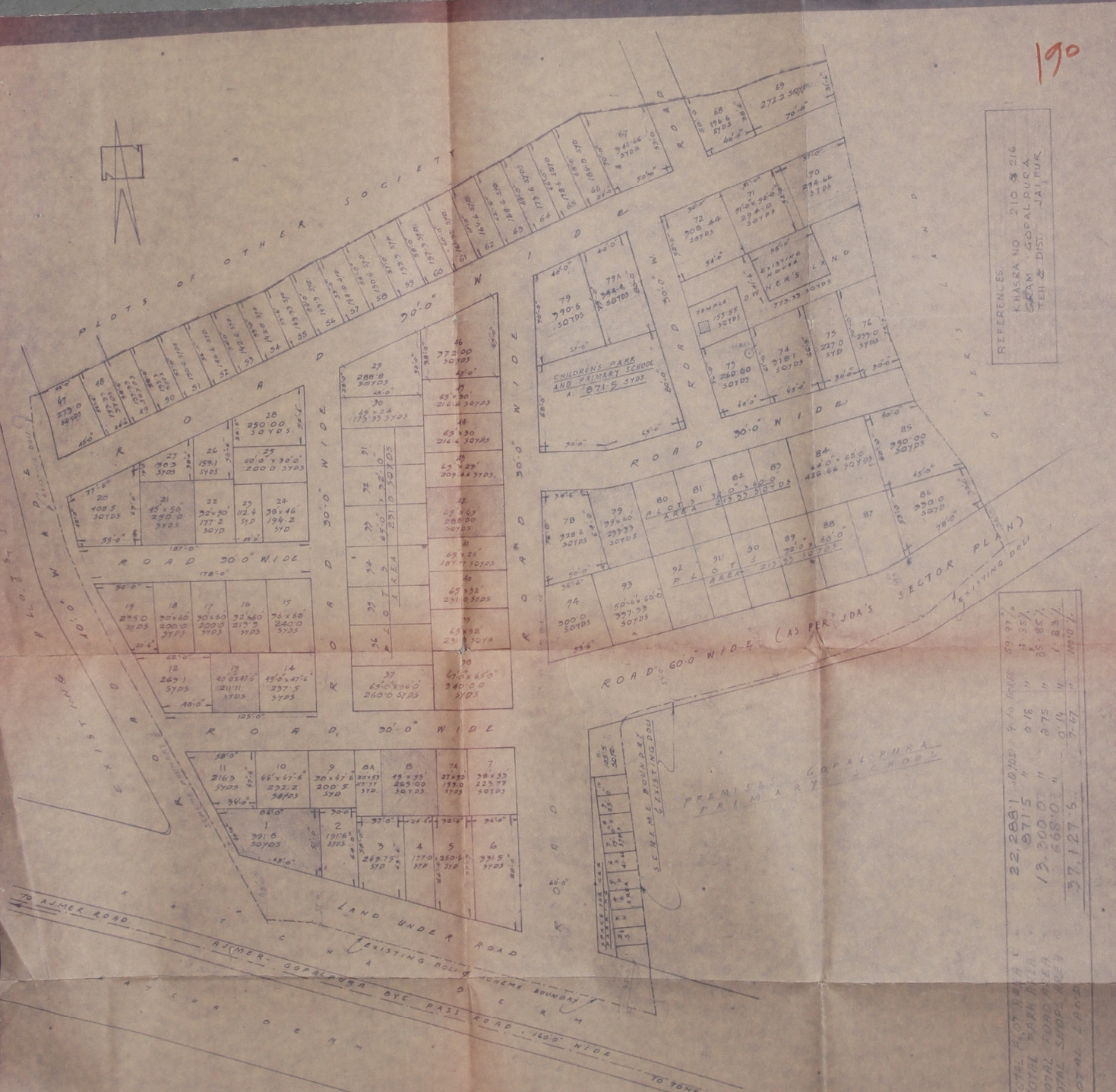

REFERENCES
 KHASRA NO 210 & 216
 GRAM GOPALPURA
 TEH & DIST. JAIPUR.

TOTAL PLOT AREA	22,288.1	50705	9.76	ACRES	69.37
TOTAL PARK AREA	871.5	"	0.18	"	4.55
TOTAL ROAD AREA	13,200.0	"	2.75	"	35.85
TOTAL SUPP. AREA	13,568.0	"	0.19	"	1.83
TOTAL LAND	37,127.5	"	7.67	"	100.00

REVISED LAY OUT PLAN OF
 PLOTS OF 'SHAKTI NAGAR' OF SHANKER
 BHAWAN NIRMAN SAHAKARI SAMITI LTD. AT
 AJMER-GOPALPURA BYE PASS ROAD, JAIPUR
 SCALE 1"=50FT



Supul
 (PC 6/16)

189

REFERENCES:
 KHASRA NO. 210 & 216
 GRAM GOPALPURA
 TEH 22 DIST. JAIPUR.



REVISED LAY OUT PLAN OF
 PLOTS OF "SHAKTI NAGAR" OF SHANKER
 BHAWAN NIRMAN SAHAKARI SAMITI LTD. AT
 AJMER-GOPALPURA BYE PASS ROAD, JAIPUR
 SCALE 1"=50FT



Signature
 (PC 6/86)

N

1. Minor adjustments will be required after the construction of roads with the following dimensions:
2. The width of the roads will be as follows:
- For roads with a width of 100' or more, the width shall be 100'.
 - For roads with a width of 80' to 100', the width shall be 80'.
 - For roads with a width of 60' to 80', the width shall be 60'.
 - Other roads shall be 40' wide.
3. Areas indicated as 'to be reserved for facilities' will be reserved for the facilities to be provided to the JDA and to be used as per the JDA plan.

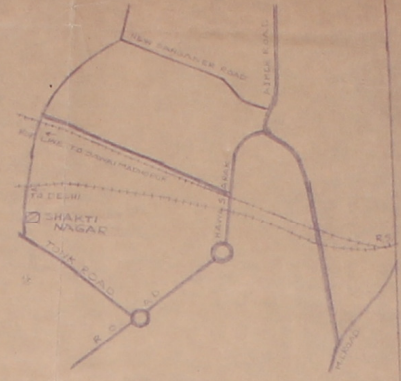

KEY PLAN

This Approval is Subject to the following conditions -

- Design of the roads to be approved by the Govt.
- Construction of the roads to be approved by the Govt.
- Construction of the roads to be approved by the Govt.
- Payment of the charges by the Society or the individual member.
- Payment of the charges by the Society or the individual member.
- Payment of the charges by the Society or the individual member.

LAY OUT PLAN NO. 41/1/15
 DATE 2-4-15

[Signature]
 जयपुर विकास प्राधिकरण,
 जयपुर



Area Analysis

	Area in Min.	%
(1) Residential	4.30	60.00
(2) Roads	2.70	39.2
(3) facilities	0.15	0.8
	7.15	100%

Totals

[Handwritten signature]
 20/12/15

PROPOSED PLOTS
 OF SHAKTI NAGAR
 SHAKTI NAGAR, LTD. AT GOPAL
 PURA ROAD, JAIPUR
 SCALE: ONE INCH EQUAL 50 FT.

REVISED LAY OUT PLAN OF PLOTS IN
 SHANTI NAGAR OF SHANTINAR BHAWAN IN
 JIRMAN SAHAKARI SAMITI LTD, AT
 GOPALPURA BYE PASS ROAD, JAIPUR-12
 SCALE 1/50 H

106



PLOTS	451 ACRT	40%
ROAD	286	
BYE PASS	015	
CLINDR	7.52	

REL KHASRA NO 216 + 207
 GRAM GOPALPURA
 DIST JAIPUR



106

REVISED LAY OUT PLAN OF PLOTS IN SHAKTI NAGAR
 OF SHANKA BHAWAN NIDMAN SHAKARI SAMITI LTD. AT
 GOPALPURA BTE PASS ROAD JAIPUR-12
 SCALE : 1"=50 FT

99



AREA ANALYSIS
 20/11/64
 11/12/64
 1/1/65
 24/1/65

REF. NUMBER NO. 216 of 207
 GRAM BHOJ PURA
 TENSIL CANGNER
 DISTRICT JAIPUR

99

REVISED LAY OUT PLAN OF PLOTS IN SHAKTI NAGAR
 OF SHANKA BHAWAN NIDMAN SAHAKARI SAMITI LTD AT
 GOPALPURA BYE PASS ROAD JAIPUR-302012
 SCALE: 1:500

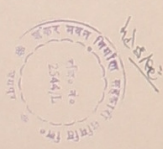
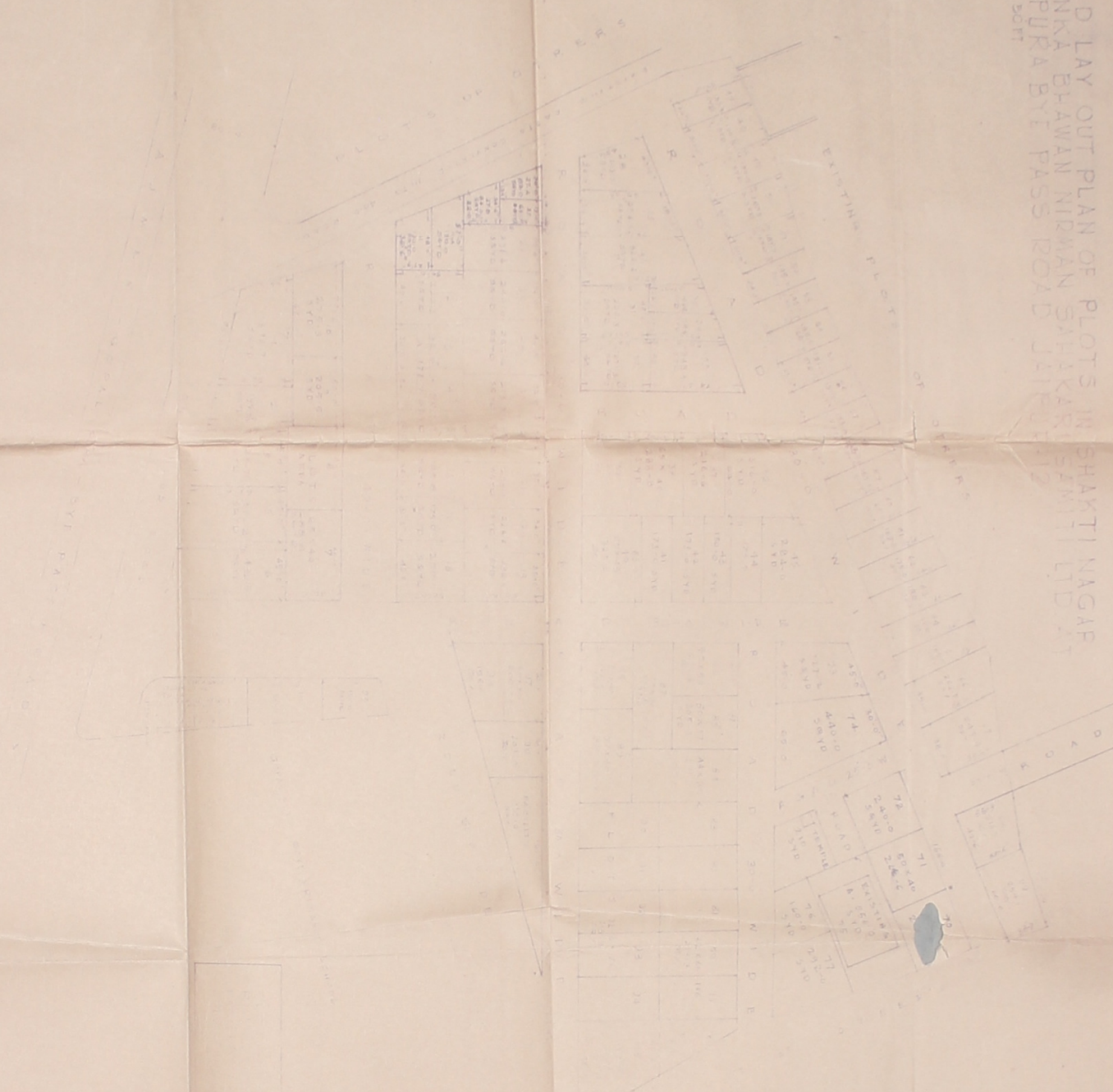

52

96

REVISED LAY OUT PLAN OF PLOTS IN SHAKTI NAGAR
 OF SHANKA BHAWAN NIDMAN SAHAKARI SAMITI LTD. AT
 GOPALPURA BYE PASS ROAD JAIPUR-12.
 SCALE : 1" = 20 FT



ALL ANALYTIC
 PLOT AREA
 ROAD: 100' x 30'
 FACILITY AREA
 100' x 30'

REF. LAGUNA NO. 100/100
 GRAM: SHANKA BHAWAN
 TASHIL: GOPALPURA
 DISTRICT: JAIPUR

67

REVISED LAY OUT PLAN OF PLOTS IN SHANTI NAGAR
OF SHANKA BHAWAN NIDHAN SAMIKHAN, SHANTI NAGAR
GOPALPURA EXT. PALS ROAD
BUILT IN 1951

95

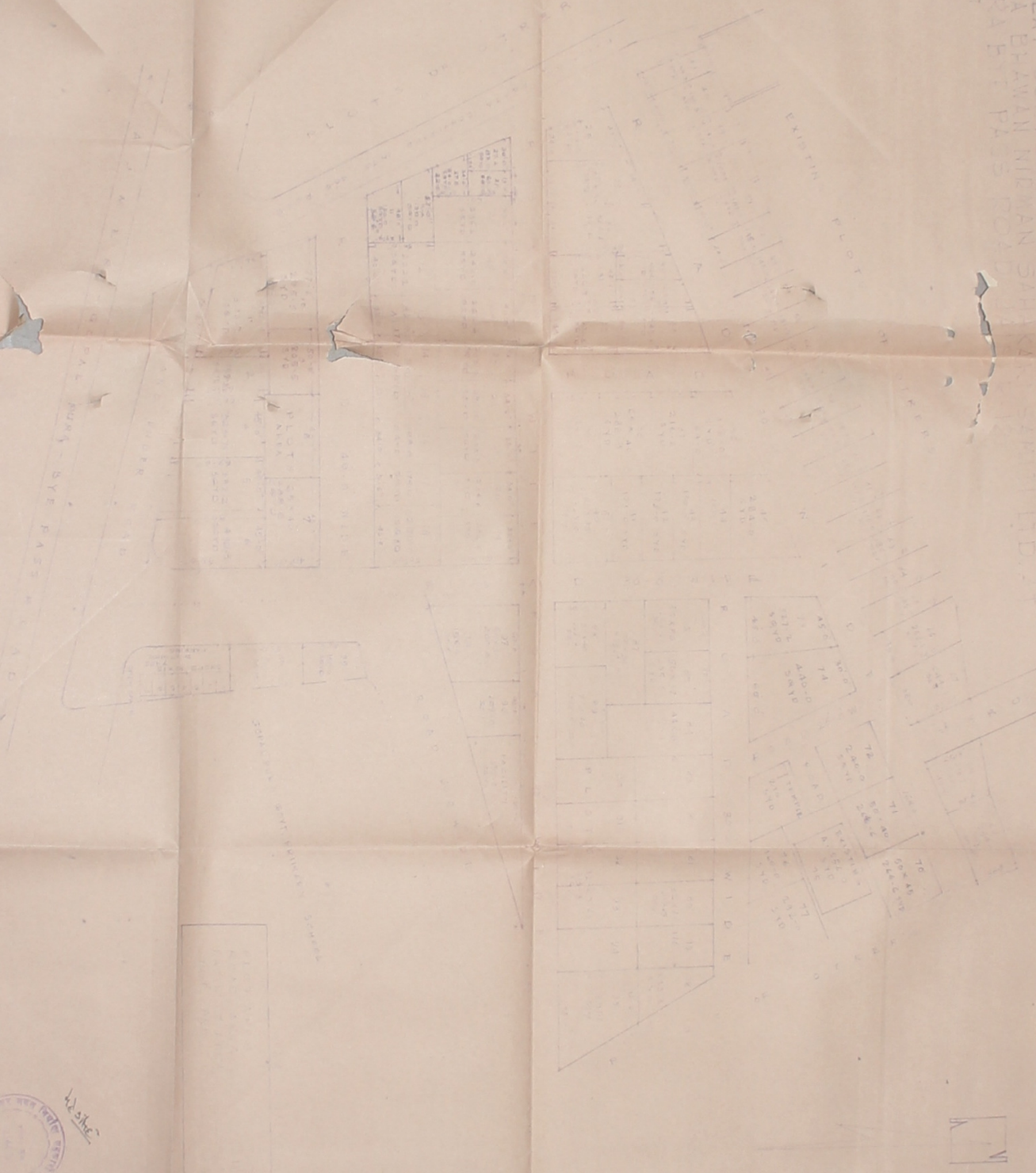

42/51/2

REVISIONS
NO. 1
DATE

REVISED LAY OUT PLAN OF PLOTS IN SHAKTI NAGAR
 OF SHANKA BHAWAN NIDHAN SAHAKARI SAMITI LTD. AT
 GOPALPURA BYE PASS ROAD JAIPUR-12.
 SCALE : 1"=50 FT

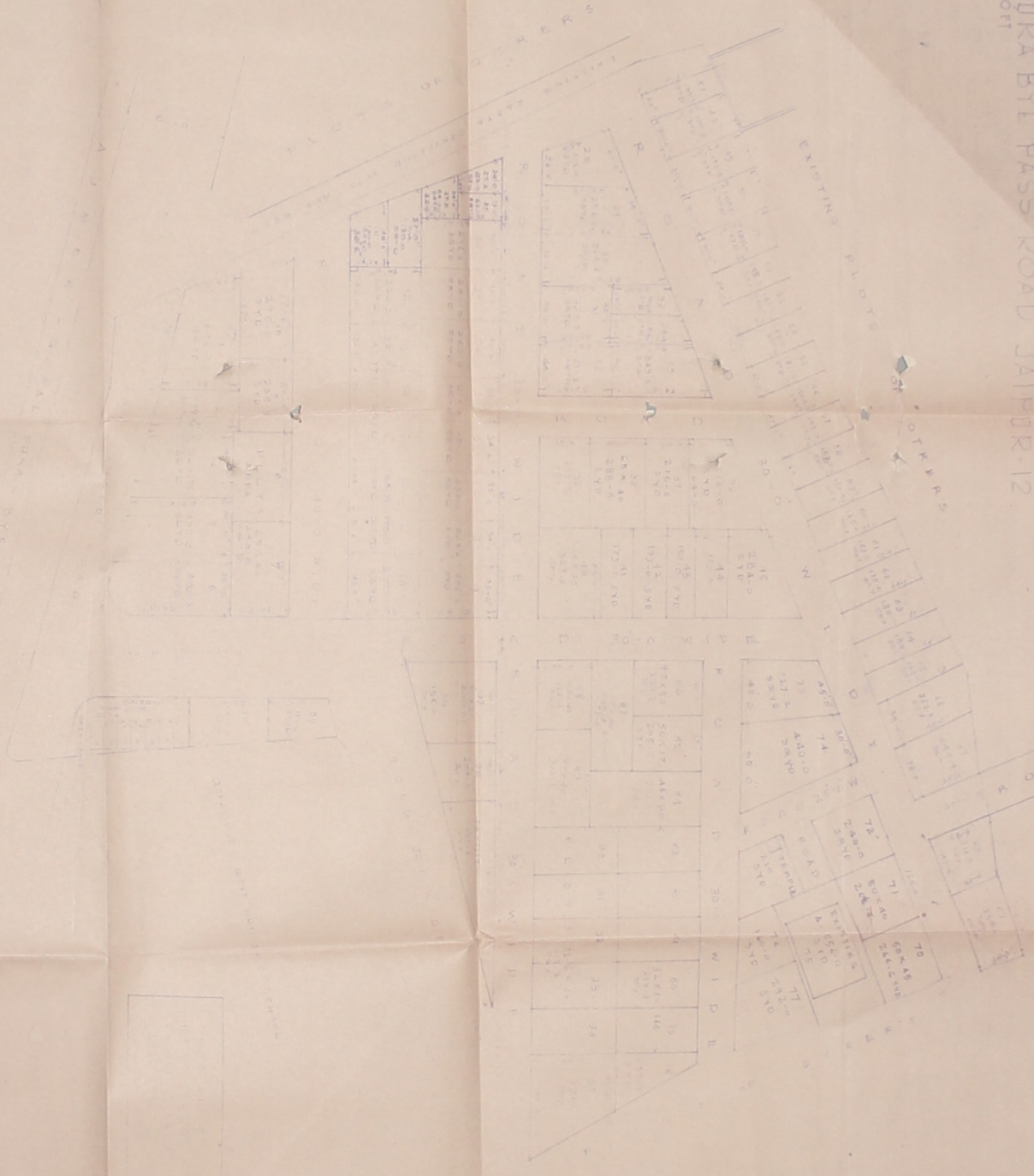

94



Handwritten signature or initials in blue ink.

Prepared by
 SANKAR K. SAHAKARI
 JAIPUR

REVISED LAY OUT PLAN OF PLOTS IN SHAKTI NAGAR
 OF SHANKA BHAWAN NIDHAN SHAKARI SAMITI LTD. AT
 GOPALPURA BYE PASS ROAD JAIPUR-12
 SCALE: 1:50 FT



Handwritten signature or initials.

REVISIONS
 NO. 1
 DATE: 10/10/57
 BY: [Signature]

REP. KHASIA RD
 SHAKARI SAMITI LTD.
 SHAKARI SAMITI LTD.
 SHAKARI SAMITI LTD.

49-
 93

REVISED LAY OUT PLAN OF PLOTS IN SHAKTI NAGAR
 OF SHANKA BHAWAN NIDHAN SAHAKARI SAMITI LTD. AT
 GOPALPURA BYE PASS ROAD JAIPUR-12.
 SCALE : 1:500 FT

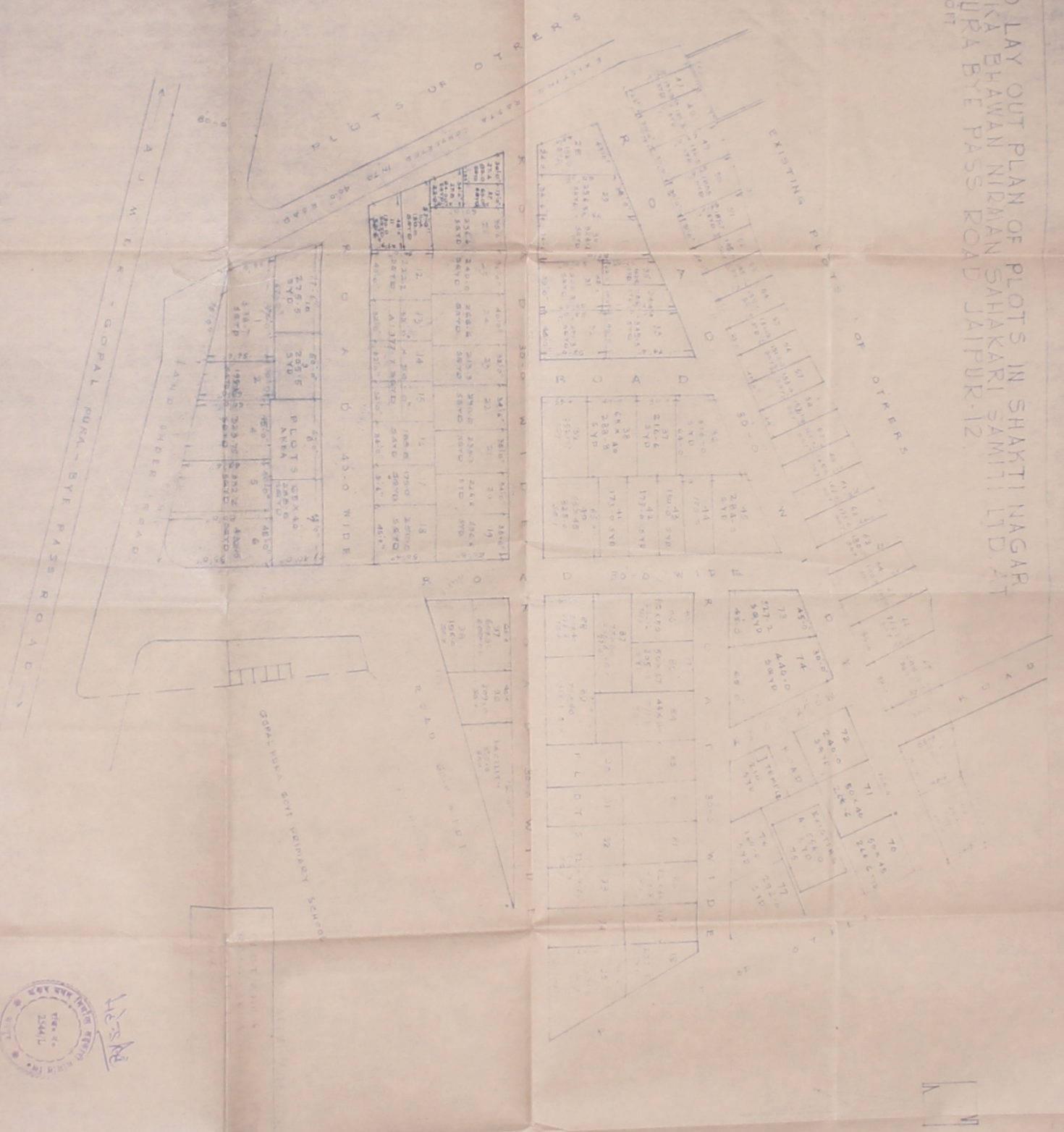

Handwritten signature

48
 92

47
91

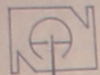

REFERENCE	
FULLY BUILT	
PARTIALLY BUILT UP	
CARRIAGE	
BOUNDRY WALL	
LONG VACANT	
ROADS (N.B.M.)	
WATER LINE	
ELECTRIC LINE	
BUCCA WELLS	
HEREME BOUNDRY	
UN ALLOTTED PLOTS	
MHASRA NO. 216 & 267	
VILLAGE GOPALPURA	
TASIL SANSANER	
DISTRICT JAIPUR	



PROPOSED PLOTS
 OF "SHANKER BHAWAN
 NIRMAN SAHAKARI SAMITY LTD.
 AT GOPAL PURA ROAD, JAIPUR.
 SCALE - ONE INCH EQUAL 30 FT.

J D A

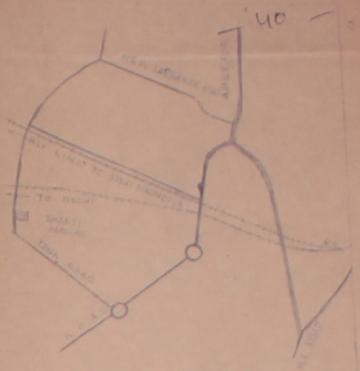
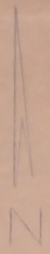

KEY PLAN



AREA ANALYSIS — 38

	AREA IN ACRES
RESIDENTIAL	4.20
ROADS	2.20
FACILITIES	0.20
TOTAL	6.60

Tr. Chit
Shankar
Shankar Nirman Sahakar Samiti Ltd.
Sector No. 4, Gopal Pura Road, Jaipur

1. All measurements as will be required for the construction of major roads will be in accordance with the Survey of India. The width of the roads will be as indicated in the plan.

2. Right of Way of Road: - From road back 10' and 20' 15' 0" 30' and 100' 30' 0" 50'

3. Other set backs, particularly in respect of plots, will be in accordance with the Sub-division Rules - 1975.

4. Areas indicated as "Reserved" in the plan will have to be handed over to the Government and will vest in the JDA.

NOTE: THE OUT PLAN APPROVED IN THE SFC. AT THE MEETING DT-4-4-83 WERE RESOLUTION NO. FOR PURPOSE OF CONVERSION.

SECTOR NO. 4

PROPOSED PLOTS OF "SHANKAR BHAWAN NIRMAN SAHAKARI SAMITI LTD. AT GOPAL PURA ROAD JAIPUR SHAKTI NAGAR"

SCALE: ONE INCH TO 100 FEET

CLIENT: SHANKAR NIRMAN SAHAKARI SAMITI LTD. H/LP/00/22/04

- This Approval is subject to Conditions -
- Discharge of land by the Govt.
 - Clearance from Urban Land Ceiling.
 - Compliance of law.
 - Payment of sub-division charges by Society or by individual owners.
 - Payment of the approval charges by Society or by individual owners.