

DETAIL 'A'

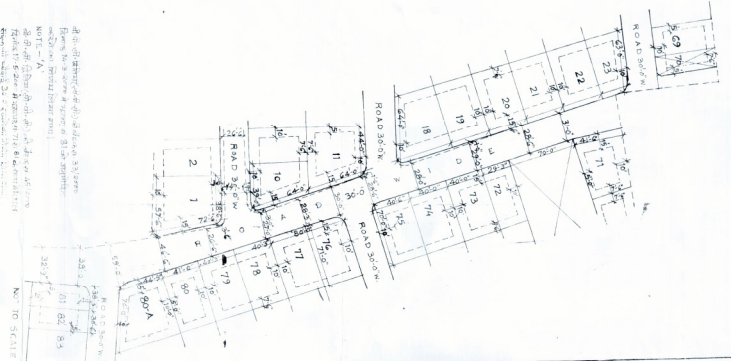

100	100	100	100	100	100
100	100	100	100	100	100
100	100	100	100	100	100
100	100	100	100	100	100
100	100	100	100	100	100
100	100	100	100	100	100

- NOTE: 1. All buildings shall be constructed in accordance with the provisions of the Building Code of the City of Manila, P. I. (1954) and the rules and regulations thereunder.
1. All buildings shall be constructed in accordance with the provisions of the Building Code of the City of Manila, P. I. (1954) and the rules and regulations thereunder.
 2. All buildings shall be constructed in accordance with the provisions of the Building Code of the City of Manila, P. I. (1954) and the rules and regulations thereunder.
 3. All buildings shall be constructed in accordance with the provisions of the Building Code of the City of Manila, P. I. (1954) and the rules and regulations thereunder.
 4. All buildings shall be constructed in accordance with the provisions of the Building Code of the City of Manila, P. I. (1954) and the rules and regulations thereunder.
 5. All buildings shall be constructed in accordance with the provisions of the Building Code of the City of Manila, P. I. (1954) and the rules and regulations thereunder.

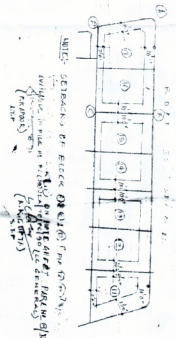

JDA

NOTE: 1. All buildings shall be constructed in accordance with the provisions of the Building Code of the City of Manila, P. I. (1954) and the rules and regulations thereunder.

2. All buildings shall be constructed in accordance with the provisions of the Building Code of the City of Manila, P. I. (1954) and the rules and regulations thereunder.

3. All buildings shall be constructed in accordance with the provisions of the Building Code of the City of Manila, P. I. (1954) and the rules and regulations thereunder.

4. All buildings shall be constructed in accordance with the provisions of the Building Code of the City of Manila, P. I. (1954) and the rules and regulations thereunder.

5. All buildings shall be constructed in accordance with the provisions of the Building Code of the City of Manila, P. I. (1954) and the rules and regulations thereunder.

DATE: 1954

BY: J. D. A.

FOR: J. D. A.

PROJECT: LAY OUT PLAN OF JAWAUPUR BLOCK-B OF RAJAH'S CO-OP HOUSING SOCIETY LTD. MANILA

10-26