

व्यं. 1/41 5/1

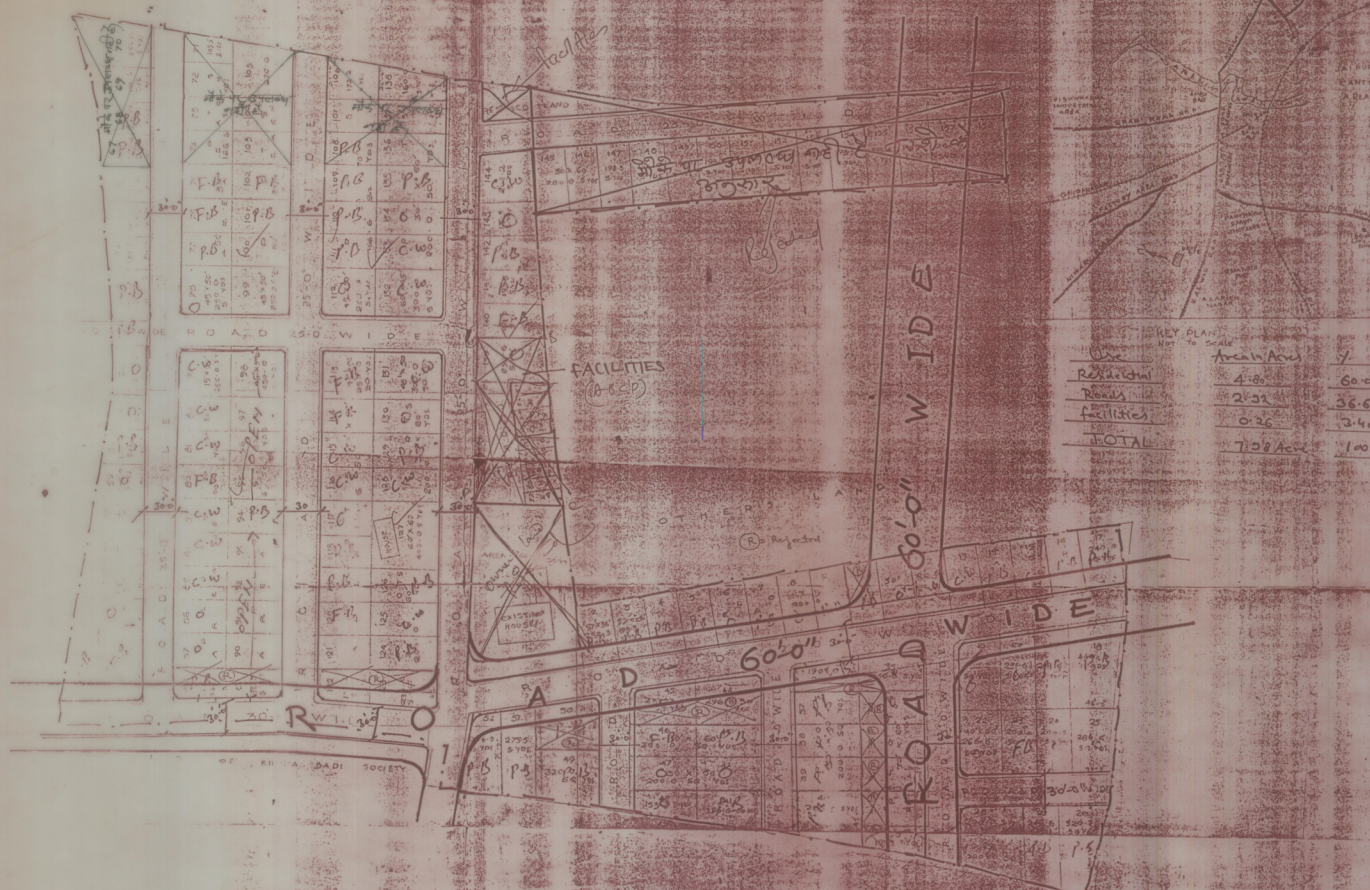

KEY PLAN

Use	Area in Ac.	
Roads	4.80	60.00
Facilities	0.26	36.60
TOTAL	7.06 Ac.	100.00

J I D A

1. All the allotments will be made in accordance with the provisions of the Act and the Rules thereunder.

2. The following conditions shall apply to all the allotments:-

(a) The allottees shall be entitled to the use of the roads and drains shown on the plan.

(b) The allottees shall be liable to pay the cost of the roads and drains shown on the plan.

(c) The allottees shall be liable to pay the cost of the water supply and sewerage works shown on the plan.

(d) The allottees shall be liable to pay the cost of the electricity supply works shown on the plan.

(e) The allottees shall be liable to pay the cost of the drainage works shown on the plan.

(f) The allottees shall be liable to pay the cost of the roads and drains shown on the plan.

(g) The allottees shall be liable to pay the cost of the water supply and sewerage works shown on the plan.

(h) The allottees shall be liable to pay the cost of the electricity supply works shown on the plan.

(i) The allottees shall be liable to pay the cost of the drainage works shown on the plan.

(j) The allottees shall be liable to pay the cost of the roads and drains shown on the plan.

(k) The allottees shall be liable to pay the cost of the water supply and sewerage works shown on the plan.

(l) The allottees shall be liable to pay the cost of the electricity supply works shown on the plan.

(m) The allottees shall be liable to pay the cost of the drainage works shown on the plan.

(n) The allottees shall be liable to pay the cost of the roads and drains shown on the plan.

(o) The allottees shall be liable to pay the cost of the water supply and sewerage works shown on the plan.

(p) The allottees shall be liable to pay the cost of the electricity supply works shown on the plan.

(q) The allottees shall be liable to pay the cost of the drainage works shown on the plan.

(r) The allottees shall be liable to pay the cost of the roads and drains shown on the plan.

(s) The allottees shall be liable to pay the cost of the water supply and sewerage works shown on the plan.

(t) The allottees shall be liable to pay the cost of the electricity supply works shown on the plan.

(u) The allottees shall be liable to pay the cost of the drainage works shown on the plan.

(v) The allottees shall be liable to pay the cost of the roads and drains shown on the plan.

(w) The allottees shall be liable to pay the cost of the water supply and sewerage works shown on the plan.

(x) The allottees shall be liable to pay the cost of the electricity supply works shown on the plan.

(y) The allottees shall be liable to pay the cost of the drainage works shown on the plan.

(z) The allottees shall be liable to pay the cost of the roads and drains shown on the plan.

RAGHUNATH PURI

अंश 1/41 (अंश 1) की योजना 28/1/1941 का
 क्र. B-10-201 का अनुसूची सं. 27-1/1/1941 का
 अनुसूची सं. 670-74, 1037, 1064, 136, 138, 17
 अनुसूची सं. 1/1/1941 के अंश 1/41 का
 अंश 1/41 का

NOTE:-
 TRACED FROM THE BLUE PRINT
 SUPPLIED BY THE SOCIETY

LAY OUT PLAN OF PLOTS OF
 SANYUKT GRAM-NIRMAN SAHA-
 KARI SAMITI LTD. AT KALWARA
 ROAD, JHOTWARA, JAIPUR.

TRACED BY
 VIRENDRA NATH
 CHECKED BY
 RAMESH SINGH

SCALE 50' = 1"

D.P.G. NO. 517/1941/1/1/1941

H.K. SHARMA, R.K. MATPURI
 ASSISTANT ENGINEER, SR. TOWN PLANNER

Compliance

Compliance