

EXISTING AREA

SNO.	LAND USE	SYMBOL	RESIDENTIAL	COMMERCIAL
1	BUILT UP	B	97	NIL
2	COMPOUND WALL	C/W	20	NIL
3	VACANT	V	01	NIL
TOTAL			118	NIL

PROPOSED AREA

SNO.	LAND USE	AREA	PERCENTAGE
1	RESIDENTIAL	23,122.90 SQ.YD	65%
2	COMMERCIAL	NIL	NIL
3	ROAD	10,760.55 SQ.YD	32%
4	FACILITY	NIL	NIL
TOTAL			33,883.45 SQ.YD

AS PER THE SITE INSPECTION & SURVEY, LAND-USE (AREA, USE) DETAIL OF THE SCHEME IS MARKED IN THE MAP

SIGNATURE: *[Signature]*  
 NAME OF THE ARCHITECT: HARI PRASAD AGARWAL  
 REGD. NO. CA / 98 / 20540

LAND OF THE SCHEME IS INSPECTED & ATTESTED BY ME AS PER THE RAJASTHAN LAND CEILING ACT CLAUSE NO.90B.  
 LAND OF THE SCHEME IS NOW UNDER THE JURISDICTION OF JDA

MAP IS RELIANT AS THE APPROVAL OF THE BPC/DIG MEETING NO. 107/2007 DATED 13-03-08

REFERENCES  
 KHASRA NO. 36, 37, 38, 42, 43, 49, 39/68 & 50  
 GRAM: MURILPURA, TEH/DIST: JAIPUR

NAME OF SOCIETY  
 MOTI BHAWAN GRAH NIRMAN SAMITI LTD.

NAME OF SCHEME  
 "SCHEME-4F (KISHOR NAGAR)"  
 AT MURILPURA VILLAGE, CHOKHU ROAD, JAIPUR

ZONE NO.	SECTION NO.	REGD. NO.
B3	198	1/

SCALE  
 1" = 50'-0"

DEGLDNO. NORTH

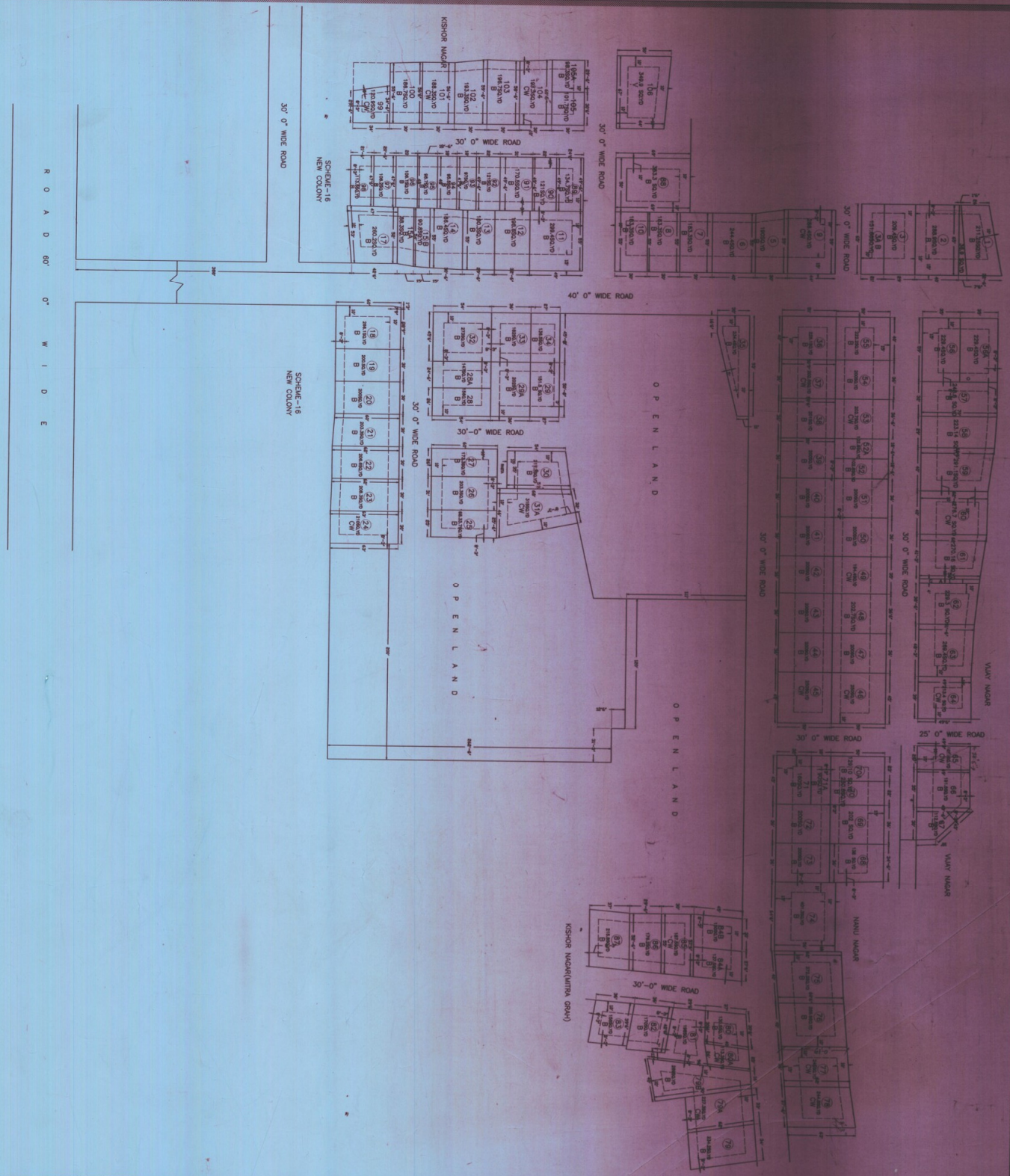

ROAD 60' WIDE

PROPOSED LAYOUT