

श्री. वि. वि. (स. वि.) 107 की संज्ञा दिनांक 19/5/07
 की तर्जिमा तैयार किया गया है।
 जिसमें कुल क्षेत्रफल 1.25 एकड़
 का विभाजन किया गया है।

DTP-7 DC-7 DTP(MP)
 J. D. A. JAIPUR

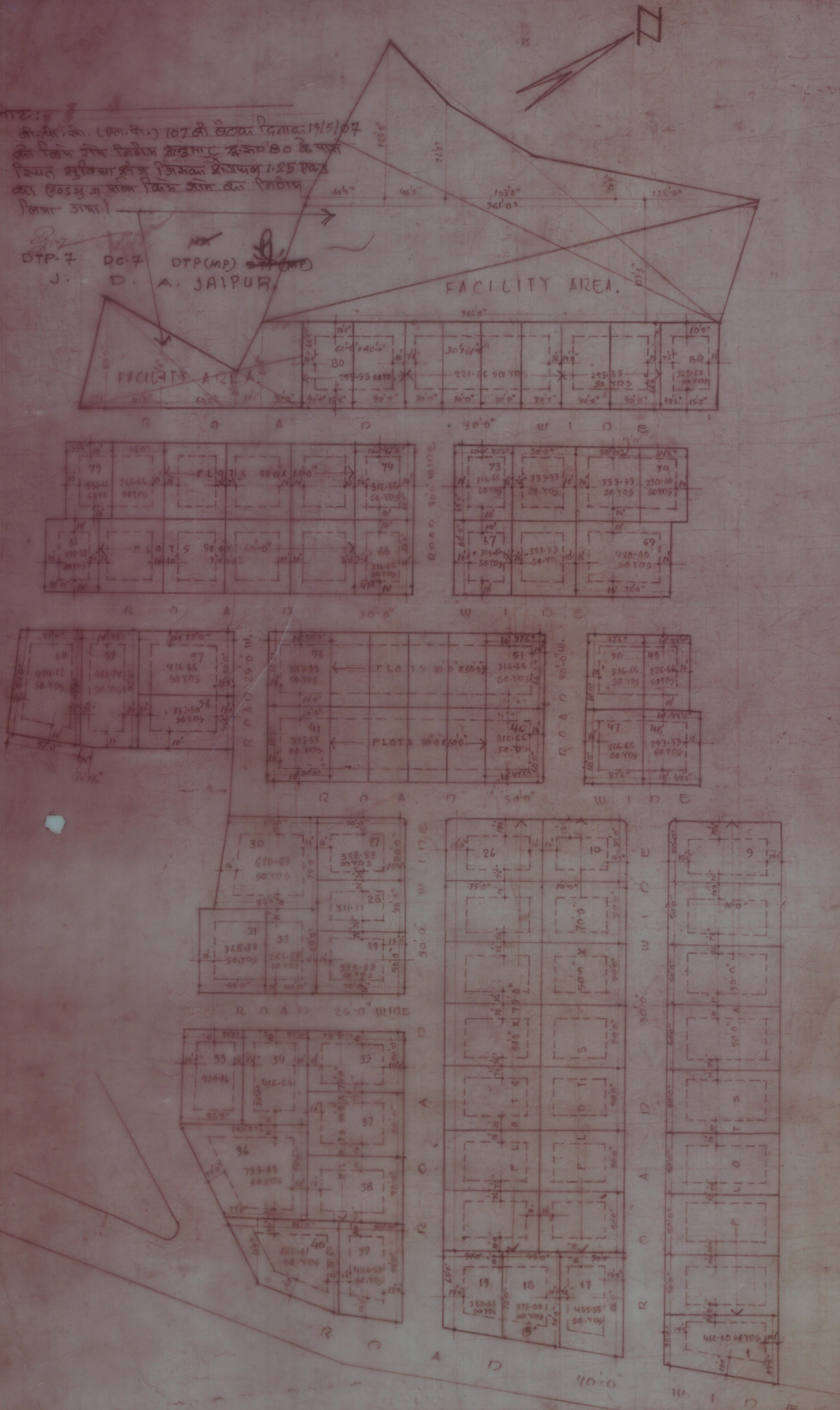

REFERENCES

AREA ANALYSIS		
1. RESIDENTIAL	6.50 ACRES	84.00%
2. ROADS	0.73 ACRES	24.00%
3. FACILITY	1.52 ACRES	15.00%
TOTAL	10.15 ACRES	100.00%

TOTAL NO OF PLOTS 88
 NOTE: SUB DIVISION PROVISIONALLY APPROVED BY THE
 BPC 'B' IN ITS MEETING DATED 15.05.07
 Sd/ (P. KAPOOR) 19.08.08
 JDA JAIPUR

NOTE: FINAL DEMARCATION PLAN WITH APPROVED SET BACKS
 ISSUED. VIDE G.P. APPROVAL IN MAIN FILE OF SCHEME ON 05.05.08.
 2. THIS SCHEME PLAN SUPERSEDES TO ALL PREVIOUSLY G.P.D. SCHEME
 PLAN OF SAME SCHEME. DRG No. R/11/12/12/1

Sd/ (P. KAPOOR)
 ASSISTANT TOWN PLANNING
 J.D.A. JAIPUR.

SOURCE: THIS LAYOUT PLAN IS TRACED FROM ORIGINAL SCHEME
 PLAN ENCLOSED IN MAIN FILE OF SCHEME.
 AT PAGE NO 95.

TRACED BY: GURGA
 COMP BY: S. R. KUMARJAI
 DRG NO: R/11/12/12/1
 SCALE 1" = 50' FOOT.

SECTOR NO 2
 SOCIETY: ARVIND NAGAR
 SCHEME: SHALIMAR BIGH.
 LOCATION: AJMER ROAD, JAIPUR.

(TRACING ATTESTED ONLY)
 Sd/ (P. KAPOOR)
 ASSISTANT TOWN PLANNING
 J.D.A. JAIPUR
 Sd/ (R. K. SHARMA)
 SENIOR TOWN PLANNING
 J.D.A. JAIPUR