

PROPOSED LAY OUT PLAN OF SHANTI NAGAR
UNDER JAI AMBEY GRAH NIRMAN SAHAKARI
SAMITI LTD. AT BENARD ROAD, JHOTWARA,
JAIPUR.

LOCATION PLAN
[AS PER MASTER PLAN SECTOR PLAN]

LAND USE AS PER MASTER PLAN 2011 RESIDENTIAL / COMMERCIAL
EXISTING POSITION OF PLOTS

- 1. FULLY/PARTLY CONSTRUCTED -B 13
- 2. PLOT COVERED WITH COMPOUND WALL -C.W. 13
- 3. OPEN PLOTS -V 34

TOTAL PLOTS 30

SCHEME'S LAND USE AS PER SITE AND TECHNICAL ANALYSIS

S. NO.	LAND USE	AREA	PERCENTAGE
1.	RESIDENTIAL	8210.94 SQ.YDS	85.79 %
2.	COMMERCIAL		
3.	ROAD	4082.28 SQ.YDS.	33.21 %
4.	FACILITY		
TOTAL		12293.20 SQ.YD.	100 %

DETAILS RELATED SITE SURVEY OF SCHEME, ROADS,
LAND USE AND AREA AS PER MASTER PLAN 2011,
HAS BEEN COMPLETED AND THE LOCATED SCHEME HAS BEEN
SHOWN ON THE DRAWING

N



Vijay Khandelwal
VIJAY KHANDLWAL
B.E. (CIVIL)

ACTION UNDER SECTION 80-B OF RAJASTHAN LAND REVENUE ACT,
DONE AND LAND CERTIFICATION AS PER SITE CONDITION OF SCHEME
DONE BY ME NOW TOTAL LAND OF SCHEME VEST WITH AUTHORITY

TEHSILDAR DY. COMMISSIONER ZONE - 8

SCHEME PLAN HAS BEEN APPROVED AND ISSUED AS PER
MEETING NO. 78 DATED: 4.12.2004 OF R.P.C.

NAME OF SOCIETY, JAI AMBEY G.N.S.S.

NAME OF SCHEME; SHANTI NAGAR.

ZONE NO. - 8 SECTOR NO. 10

SCALE; 1" = 50' DRG. NO.

<i>[Signature]</i>	<i>[Signature]</i>	39
A.T.P. ZONE	D.T.P.	S.T.P.

JAIPUR DEVELOPMENT AUTHORITY JAIPUR

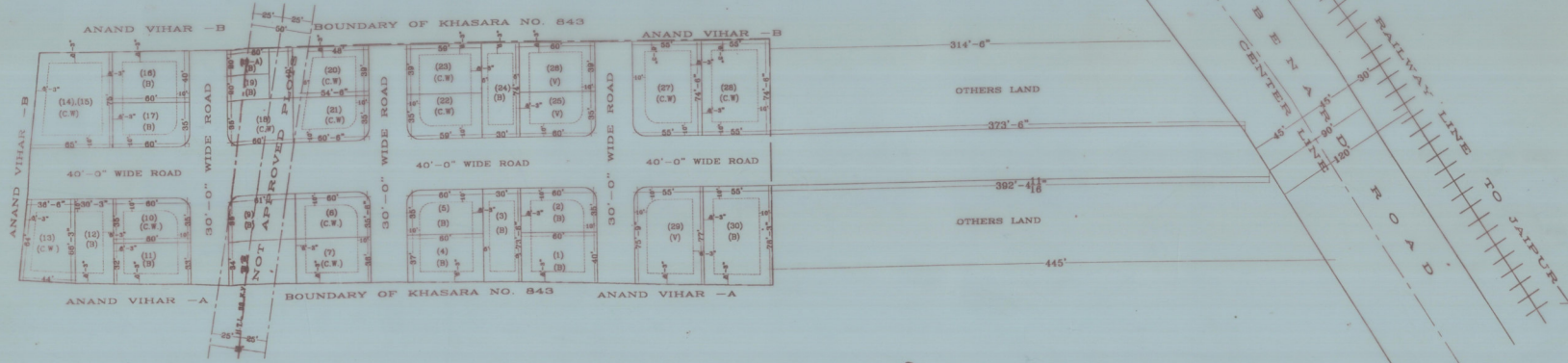

NOTE:-
PLOT NO. 8, 9, 18, 19, AND 19-A NOT APPROVED
DUE TO EFFECTED BY H.T. LINE