

JDA

(AS PER SECTOR PLAN)

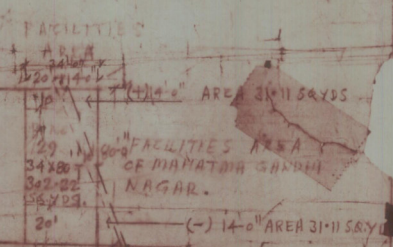

REVISED POSITION OF A SIZE OF PLOT NO 29 HAS BEEN MODIFIED AS PER DPC (CPC) DECISION DATED 19-8-93 AND HAVE BEEN SHOWN AT A

ATP (CPC) JDA
DTP (CPC) JDA
STP (CPC) JDA

AREA ANALYSIS:-

RESIDENTIAL	2.02 ACRE	68.50%
ROAD	0.49	16.00%
FACILITIES	0.46	15.50%
TOTAL	2.97 ACRE	100.00%

COPY TO ADM. (L.C.) FOR INFORMATION AND N.A. CONVERSION ORDER MAY BE ISSUED WHEN CONVERSION AMOUNT IS DEPOSITED TO THE TUNE OF CATEGORY 'I' 10.50% AND ABOVE.

SUB DIVISION PROVISIONALLY APPROVED BY THE BUILDING PLAN COMMITTEE 'B' IN ITS MEETING HELD ON 22-11-89

SOURCE - SITE PLAN IS TAKEN FROM TRUE COPY OBTAIN BY SDO (L.C.) JDA (S/D) JDA

DATE 17.5.1993

TRACED BY: DRG. NO. R/LP/H/90/2/1
CHK. BY: SCALE: 1" = 50'

SCHEME NO. 12
SOCIETY: GULAB BARI H.C. SOCIETY
SCHEME: TEACHERS COLONY
LOCATION: AJMLA ROAD