

JIDVA

श्रीधर शर्मा
आर्किटेक्ट, सचेतनोस

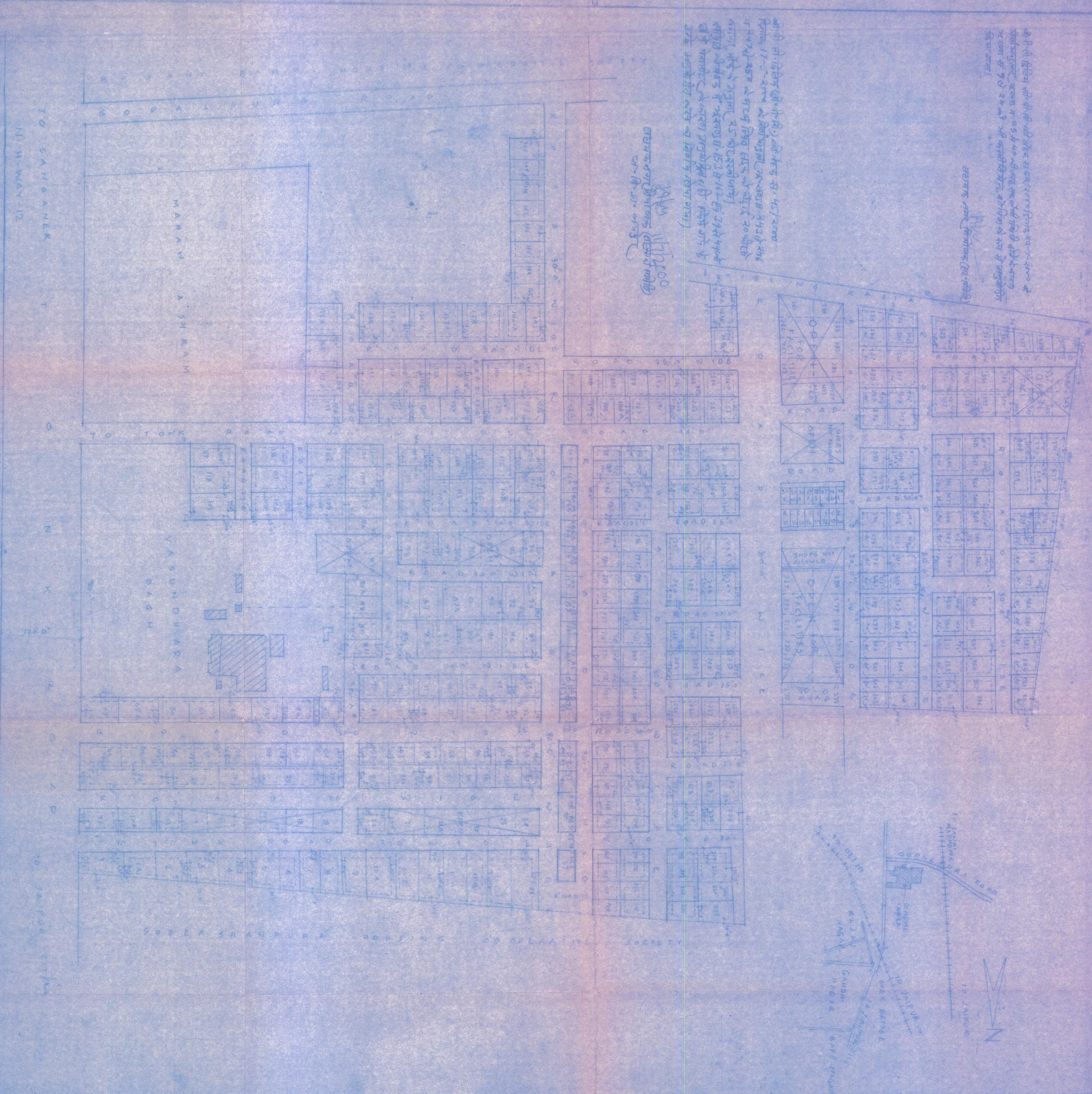

1. The plan is submitted for the purpose of...
 2. The area of the plot is...
 3. The plan is drawn in accordance with...
 4. The plan is approved by the...
 5. The plan is valid for...

1. The plan is submitted for the purpose of...
 2. The area of the plot is...
 3. The plan is drawn in accordance with...
 4. The plan is approved by the...
 5. The plan is valid for...

NOTES:

SET BACKS OF P.N. 200 TO 210 IS REVISED AS PER THE APPROVAL OF D.B. (P.N. 9) SECT. ON FILE NO. J.D.A. / 3287 / E.O. 24 / S.R. 849 / 25 AN. 1944. 26/10/87 N. DATED 22/6/85.

DESIGNED BY: ARCHITECT
 J. D. A. JAPUR

NOTE: DRAWING IS TO BE USED FROM THE...
 DRAWING IS TO BE USED FROM THE...
 DRAWING IS TO BE USED FROM THE...

REVISED LAY-OUT PLAN OF
 SHARAT BHAWAN NIKASHAN SANGH
 24 UNIT H.E.S. DWASUNOVARA
 BAGH ON TORK ROAD JAPUR

(BY) ARCHITECT
 J. D. A. JAPUR