

SCHEDULE OF PLOTS.

CLASS	SIZE	FRONT SET-BACK	SIDE SET-BACK	REAR SET-BACK	AREA	NO. OF PLOTS
A	80'x20'	30'	10' (ON ONE SIDE)	15'	1066.600 SQ. M.	28
B	70'x110'	30'	10' (ON ONE SIDE)	15'	855.500 SQ. M.	4
C	60'x90'	20'	10' (ON ONE SIDE)	10'	600.000 SQ. M.	37
D	50'x70'	20'	5' (ON ONE SIDE)	5'	388.000 SQ. M.	189
E	30'x60'	10'	7 1/2' (ON ONE SIDE)	7 1/2' (ON ONE SIDE)	200.000 SQ. M.	242
	50'x30'	20'	7 1/2' (ON ONE SIDE)	10'	500.000 SQ. M.	29
	40'x70'	15'	10' (ON ONE SIDE)	10'	333.300 SQ. M.	17
	30'x60'	15'	10' (ON ONE SIDE)	10'	200.000 SQ. M.	17
						TOTAL 600 PLOTS

COMMERCIAL.

SHOP WITH VERANDAH	50'x12'x6"	32
SHOP WITH VERANDAH	50'x20'x6"	28
		TOTAL NO. OF SHOPS 60

NOTE:-
 THE LAND BETWEEN EXISTING JAIPUR METAL SHEDS AND THE PROPOSED SCHEME IS A WASTE SPACE NEAR THE E-305 OF AMBA BARI SCHEME HAS BEEN RE-PLANNED AS PER DRG. NO. R/1/1/JDA/9/1/54.

ASSTD. TOWN PLANNER
 JDA, JAIPUR

DEPUTY TOWN PLANNER
 JDA, JAIPUR

REVISED PLAN OF AMBA-BARI SCHEME ON JHOTWARA ROAD

TRACED BY	SCALE: 100 FT TO AN INCH	ISSUED ON
CHECKED BY	DATE: 11/12/14	
N. C. NARRA ASSTT. TOWN PLANNER		A. K. GUPTA DEPUTY TOWN PLANNER

COMPALED BY ATTESTED
 9-12-14
 ASSIST. ENGINEER
 J. D. A. JAIPUR

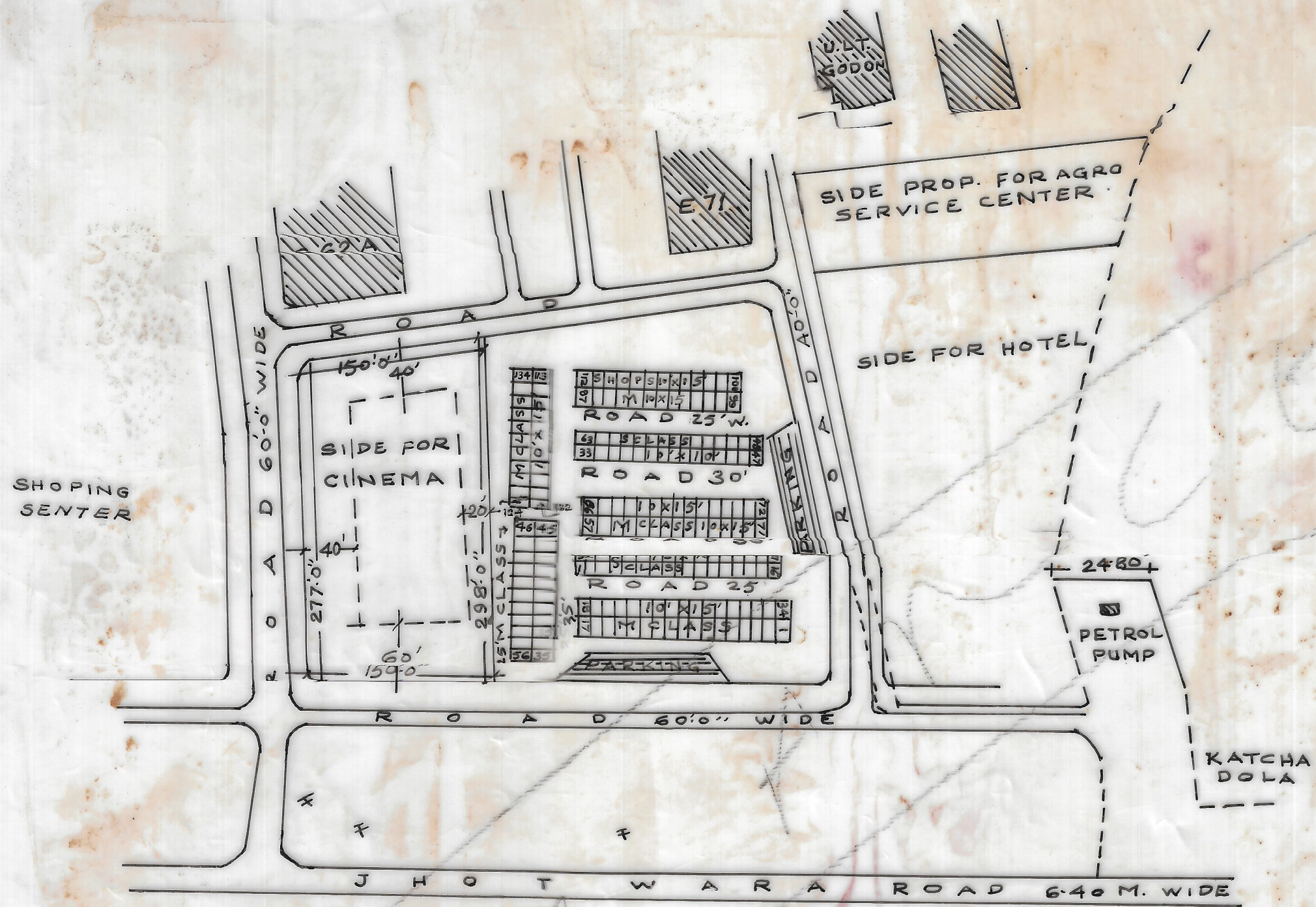

SCHEDULES OF SHOPS.

S.N.	SIZE	AREA	NO OF SHOPS
1. SCALAS	10' x 10'	100 SQ YD	62 NOS
2. M CLASS	10' x 15'	16.56 SQ YD	134 N.S.
			TOTAL 196

NOTE:-
 1. D.T.P. सा. आदेश दिनांक 9-4-81 पत्रावली M 36 अनु 28 के अनुसार दुकानों पर नम्बर अंकित कर दिया गया है।
 ए. नैज सिंह राठी
 22-4-81

PART PLAN SHOWING THE PROPOSED SHOPS IN AMBA BARI SCHEME ON JHOTWARA ROAD

COMPAKED BY J.D.A.
 ATTESTED J.D.A. 17/12/84
 ASSIST. ENGINEER
 J. D. A. JAIPUR

17/12/84

DRAW BY T.C. RATHOR	SCALE:- 100' = AN INCH DRG NO E4430P1977	ISSUED ON DATE 14.12.77
<u>s/d</u> (P. N. SHARMA) ASSISTANT TOWNPLANEER	<u>s/d</u> 14.12.77 (Y. K. BHATT) DEPUTY TOWN PLANNER	

IMPROVE MENT TRUST J A I P U R.